

# POWER CLEAN 2.0C

## FEATURES:

- » 2HP Industrial Motor, Totally-Enclosed, Fan-Cooled
- » 2.1 GPM, 3 Cylinder, Stainless Steel Lined, Ceramic Plunger Pump
- » Master Control Panel w/ LED Readout for Current Status & Troubleshooting
- » SSR w/ Integrated LED for Basic System Status
- » Dual Chemical Injection System w/ Stainless Steel Injectors and Post Pump Injection
- » Anti-Backflow/Anti-Siphon Protection w/ 1" Air Gap via Water Level Float Tank
- » Low Water Shut-Off protection
- » Thermal Limit Switch for Over Temp Protection (150° Max Water Temp)
- » Bleeder Valve Assembly
- » Includes Water Filter Assembly, Replacement Filter Cartridge, and Oil
- » Unit Comes Ready to Wire. **Does Not include Power Cord.**
- » Shipping Weight: 266 lbs

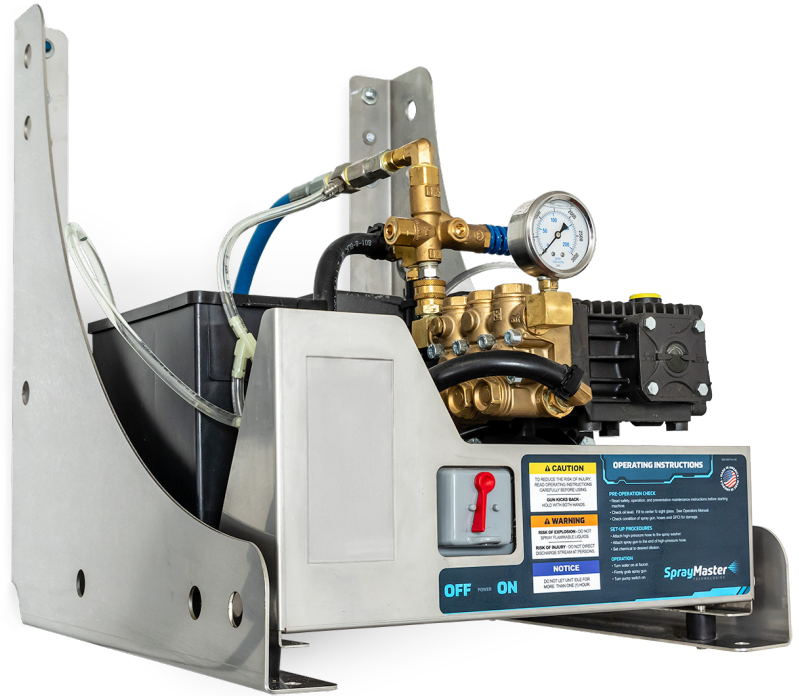

### 300-5131

Power Clean 2.0c, 2.1 gpm @ 1100 PSI

**Power Rating:** 120vAC/20A

Dedicated Circuit for each unit

*\*Left: Shown with optional Stainless Steel Cover and Wall Mounting Brackets*

## EQUIPMENT SPECS:

### CLEARANCES

- » Left Side 10"
- » Right Side 10"
- » Overhead 21"
- » Above Finished Floor 36"
- » Front 16"

### PLUMBING

3/4" / 2cm Hose Bib with 5 gpm / .14Lpm @ Min. 30 to 80 psi / 20.6 to 5.5 bars. If Warm Water is required, 150° F / 65.5° C Max.

### ELECTRICAL

- » One (1) 120v 60Hz, Single Phase 20A, GFCI Protected 'Dedicated Circuit'
- » One (1) 120v 60Hz, Single Phase 15A GFCI Protected, Nema 5-15R Outlet

### CHEMICAL DILUTION

*Dual Chemical Metering Valves* accurately adjust chemical metering to your chemical specifications.

## INSTALLATION SPECS:

### ELECTRICAL

- » One (1) 120v 60Hz, Single Phase 20A, GFCI Protected 'Dedicated Circuit'
- » One (1) 120v 60Hz, Single Phase 15A GFCI Protected, Nema 5-15R Outlet

### WATER

One (1) water outlet with standard 3/4" / 1.9cm hose bib with shut-off valve. A pressure gauge in the water line can be helpful although it is not mandatory. A minimum of 5 gal / 19L per minute and a line pressure not less than 30 psi / 20.6 bars, and not more than 80psi / 5.5 bars, is required.

*(Option: if warm water outlet is needed - 150° F / 65.5° C MAX)*

### LOCATION

Heated utility room or closet with ventilation. Minimum 24" / 60.96cm clearance above unit is required. The unit can be serviced without removing it from the wall.

### GENERAL RECOMMENDATIONS

Floor drains are essential in new facilities to receive the greatest utilization and maximum efficiency of your **Spray Master** pressure washer. Materials and wall coverings which can be cleaned with pressurized water are desirable. Locate electrical outlets above washing areas.

FRONT

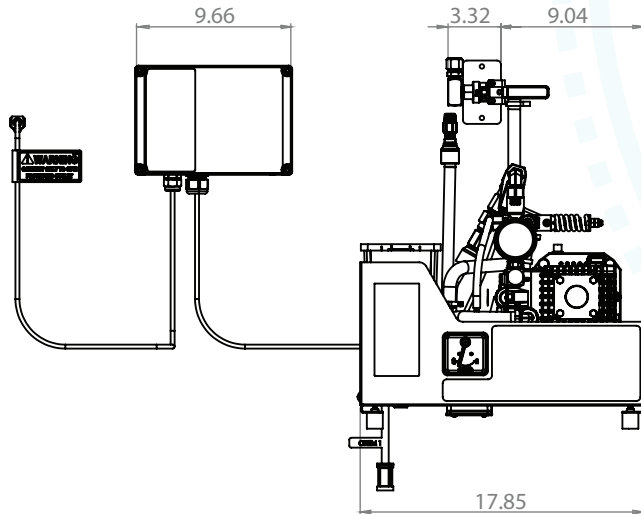

TOP

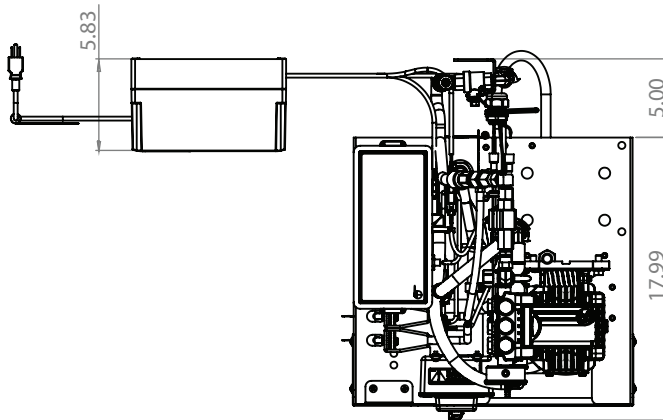

SIDE

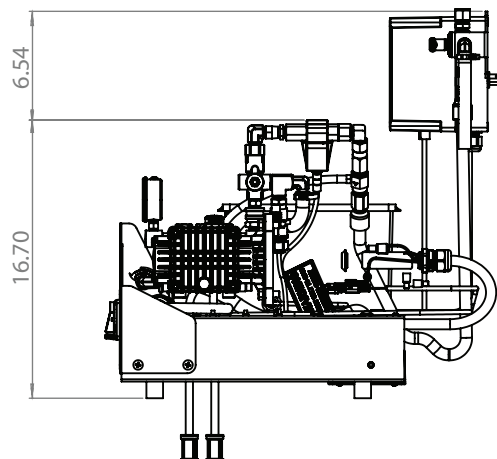

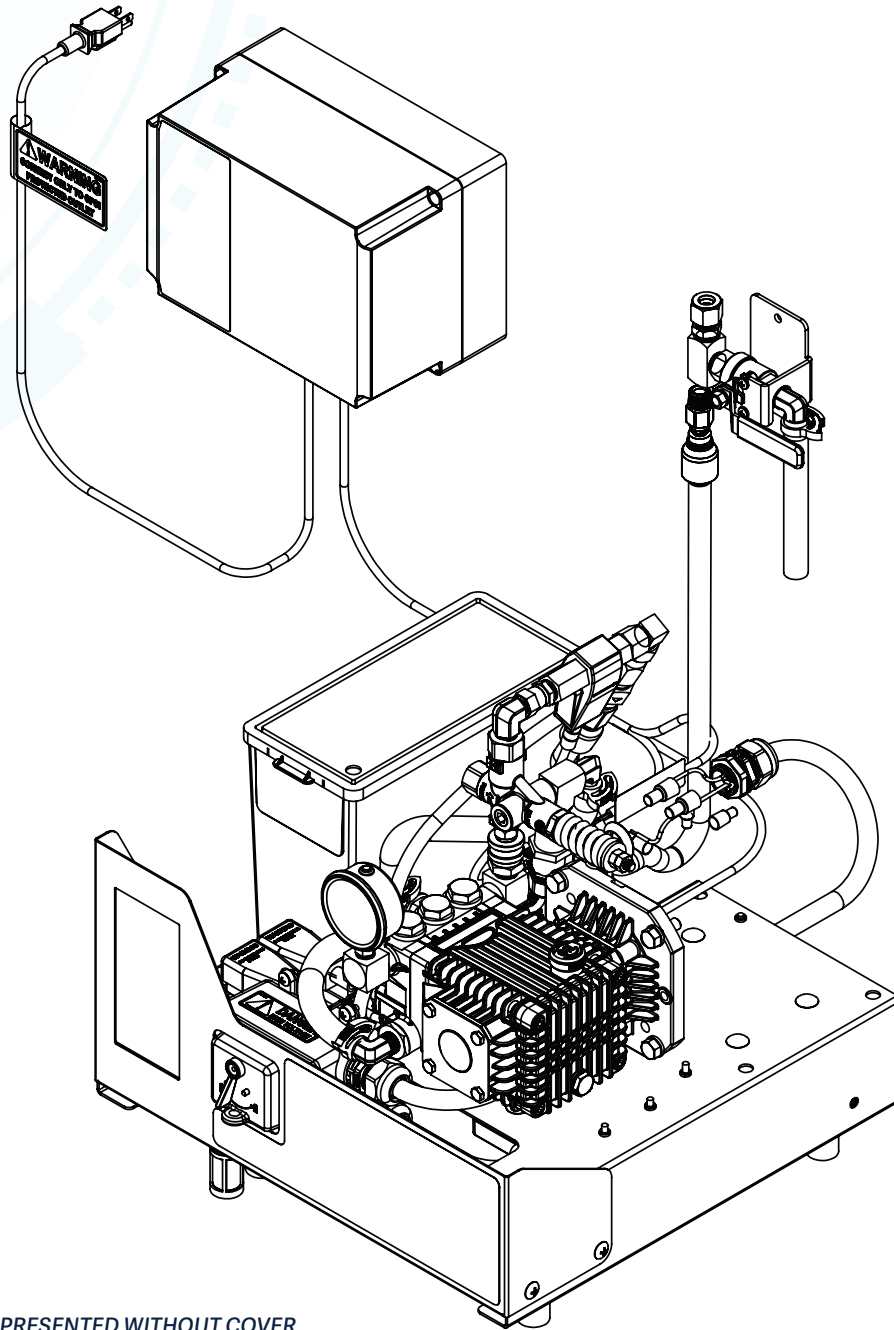

\*REPRESENTED WITHOUT COVER

## SYSTEM REQUIREMENTS:

- » One (1) 120v 60Hz, Single Phase 20A, GFCI Protected 'Dedicated Circuit'
- » One (1) 120v 60Hz, Single Phase 15A GFCI Protected, Nema 5-15R Outlet
- » 3/4" Backing required in studded walls.

NOTE: Electrical, Water, and Backing are not supplied by Spray Master.

### AMBIENT WATER SUPPLY

**Recommended Temp:** Cold water, 5 gpm @ minimum (30-60 psi) with a maximum of 80 PSI with 3/4" Hose Bib (*one for each unit*)

**Maximum Temp:** 150° F / 65.5 C, 5 gpm @ minimum (30-60 psi) with a maximum of 80 psi with a 3/4" Hose Bib (*one for each unit*)

